



Attachment B



ALLOT.
 PLAN OF ~~FOR~~ 103
 CITY OF NEWCASTLE

PARISH *Newcastle*
 LAND DISTRICT *Newcastle*

COUNTY *Northumberland*
 CITY *Newcastle*

Schedule Extract Attachment NSD1897/2017 (NN2017/008)
 Map of the application area, Attachment B of the application
 Page 2 of 2, A4, 26/10/2017

NOTATION PLAN
 1. Definitions: This Survey
 Deeds Book 103171
 that the same shall be a
 718 ORIGINAL AT FOOT
 OF THE ORIGINAL
 DATE 12 AUG 1969

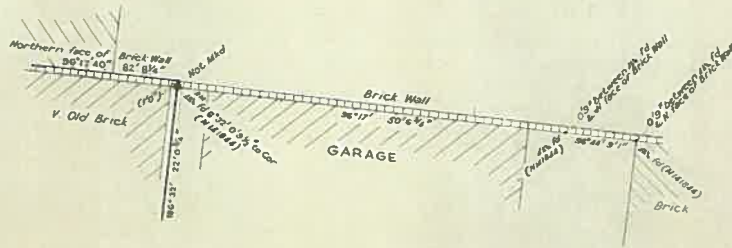
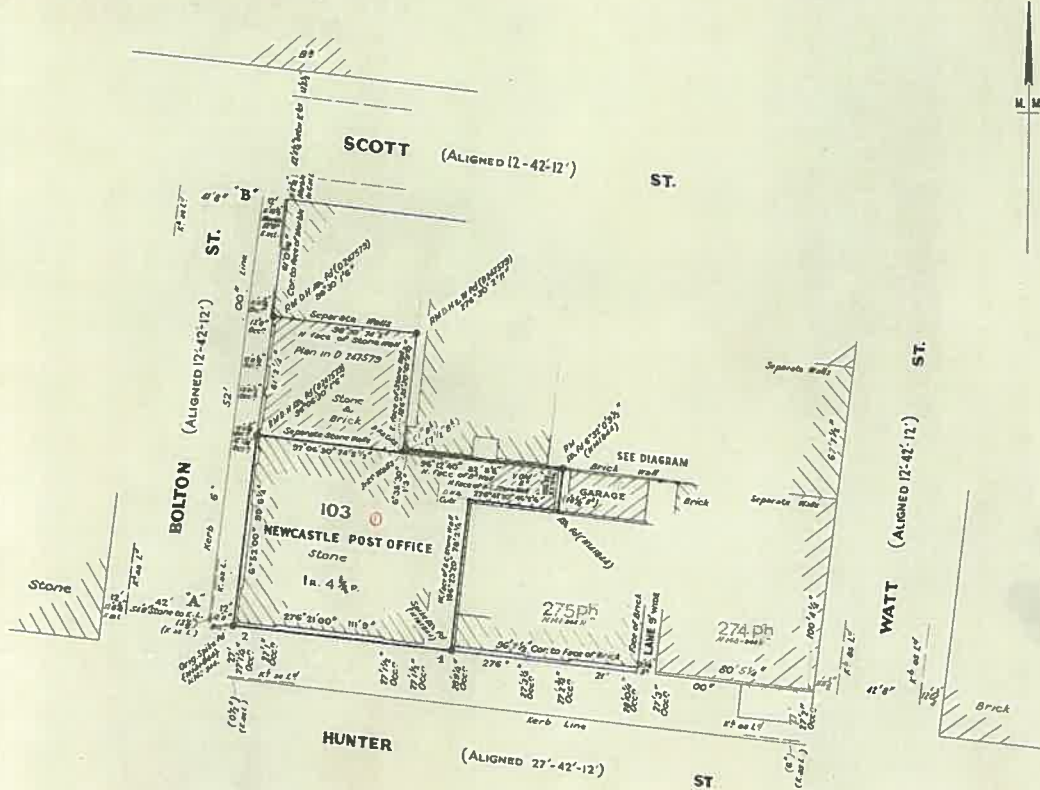

DIAGRAM
 Scale: 10 ft to an inch

PLAN MICROFILMED
 NO ADDITIONS OR AMENDMENTS TO BE MADE

Checked on Hand [Signature]
 12/10/17

SCALE 40 FT TO AN INCH All measurements shown in feet & inches

CANCELS Plan N 142-644
 City of Newcastle Roll of 20th March, 1965.
 Newcastle City Councils Town and Country Planning Scheme.
 Allot 103 Newcastle Post Office Site, Commonwealth Transferred Property
 Grant issued to Commonwealth of Australia Dec 2305

REFERENCE MARKS

CORNER	BEARING	FROM	DISTANCE	NO ON TREE
1	189° 32'	D.M. 103 278	1' 11 1/2"	
2	251° 23'	D.M. 103	1' 0 1/2"	

SURROUNDING AREA:
 12063.92 Sq. ft.

AZIMUTH TAKEN FROM A-B
 FIELD BOOK FEES 1-4 PAGES
 I Neville Hall
 a Surveyor registered under the Surveyors Act 1929-1946, hereby
 certify that the survey represented in this plan is accurate and has
 been made by me
 in accordance with
 the Survey Practice Regulations 1932 and the special requirements
 of the Department of Lands and was completed on 20th Nov 1967
 Signature *Neville Hall*
 Surveyor registered under the Surveyors Act 1929-1946
 CHECKED & CHARTED BY *W.R. Thomas*
 PLAN APPROVED
 AUTHORIZED OFFICER
 26 1969
 DEPT OF THE INTERIOR
 REG. NO. 14346

This space for office use only

NOTATION PLAN